



## Sandringham Cast Iron Bath

**#2163 | 70 1/8" L x 31 1/2" W x 23" H**  
401 lbs, 63 Gallons

Cheviot Products' cast iron bathtubs are hand-made in Europe with the finest materials. Fired with a thick coating of AA grade titanium-based enamel for unparalleled hardness and non-porosity, the extremely durable surface is easy to clean and resistant to stains, bacteria and other microbes. Cast iron also keeps your bath warm for the longest possible time.

### Rim Configuration

Continuous Rolled Rim

### Colours

White Interior & Exterior  
White Interior & Custom  
Colour Exterior

### Note

Rough-in dimensions may vary +/- 1/2" and are subject to change.  
No responsibility is assumed by Cheviot Products Inc.  
One Year Limited Warranty against manufacturer's defects.

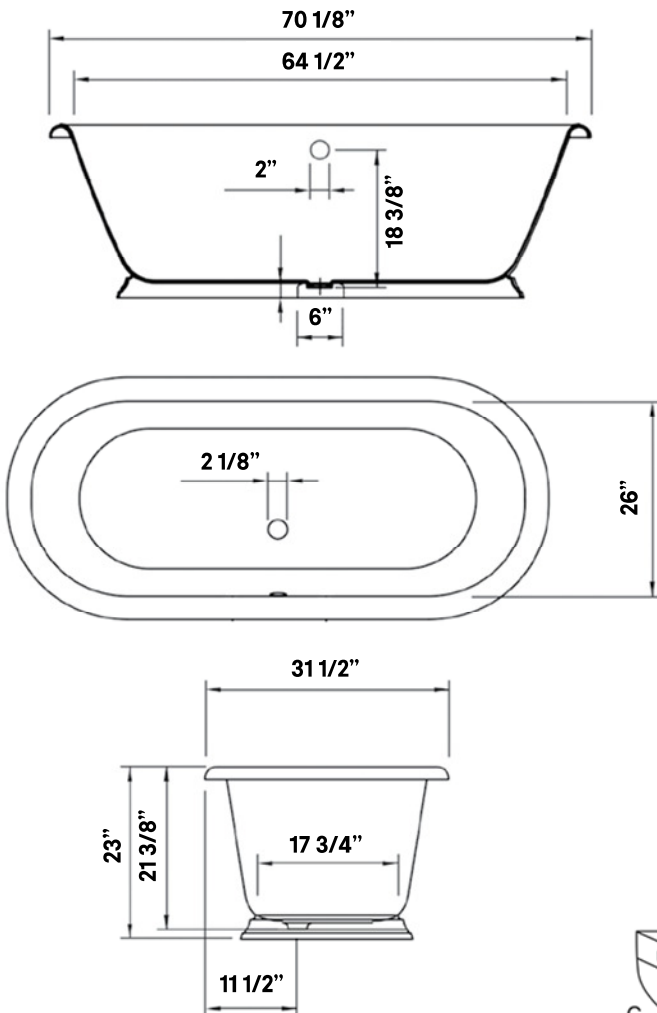

### Related Products



**#7550 Contemporary**  
Free-Standing Tub Filler with  
Hand Shower



**#2222 Waste & Overflow**



**#3970 Heavy Duty**  
Water Supply Lines



**#3980 Heavy Duty**  
Water Supply Lines