

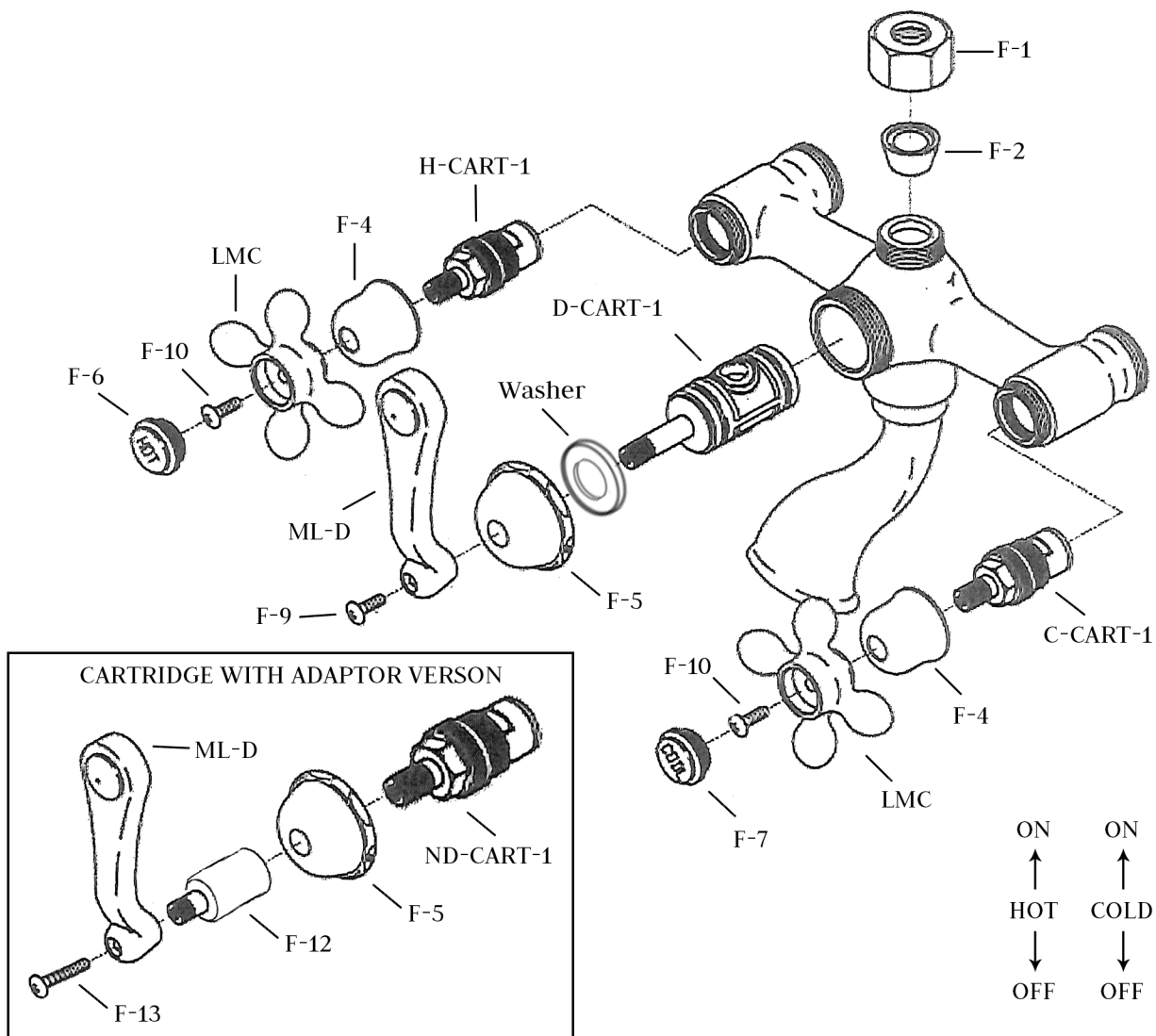

## English Telephone Faucet Body

by Randolph Morris

Item#: 146S



Unpack and check all the parts, and read the instructions.

PART NO.	DESCRIPTION	QTY
C-CART-1	COLD CARTRIDGE (BLUE)	1
D-CART-1	DIVERTER CARTRIDGE	1
F-1	RISER NUT	1
F-2	RISER CONE WASHER	1
F-4	BELL NUT - HOT & COLD	2
F-5	DIVERTER BELL NUT	1
F-6	HOT CERAMIC BUTTON	1
F-7	COLD CERAMIC BUTTON	1
F-9	FINISHED SCREW	1
F-10	UNFINISHED SCREW	2
F-12	ADAPTOR	1
F-13	LONG FINISHED SCREW	1
H-CART-1	HOT CARTRIDGE (RED)	1
LMC	CROSS HANDLE	2
ML-D	DIVERTER HANDLE	1
ND-CART-1	DIVERTER CARTRIDGE (ADAPTOR VERSION)	1

**Approximate Measurements.** All products and specifications are subject to change without notice. Randolph Morris is not responsible for typographical and/or dimensional errors. Typographical errors are subject to correction.

## COUPLER & SWING ARM PART SETS

**\*\*NOTE:** You may not receive all part sets listed below. Please refer to your order for your specific product.\*\*

**DECK MOUNT COUPLERS** - Either of these couplers can be used to attach a tub faucet to the rim of a tub.

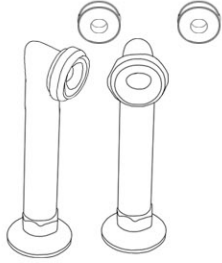

6" Deck Mount Couplers  
Part: 200

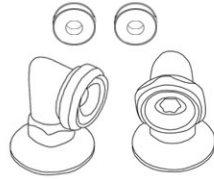

2" Deck Mount Couplers  
Part: 202

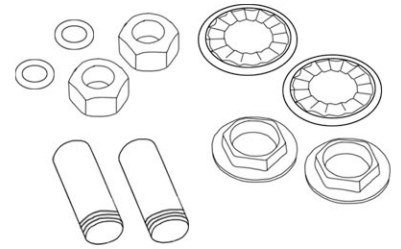

Deck Mount Hook Ups  
Part: RMT500 included in box 200 or 202

**BATHROOM WALL MOUNT COUPLERS** - Either of these couplers can be used to attach a tub faucet to the rim of a tub.

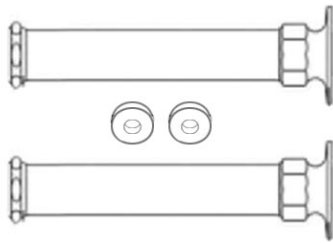

6" Bathroom Wall Mount Couplers  
Part: 170

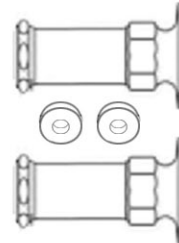

2" Bathroom Wall Mount Couplers  
Part: 160

**TUB WALL MOUNT COUPLERS** - Either of these couplers can be used to attach a tub faucet to the inside wall of a tub.

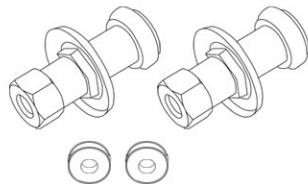

Straight Tub Wall Mount Couplers  
Part: 350

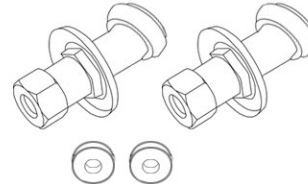

Adjustable Tub Wall Mount Couplers  
Part: A100

**DECK MOUNT /  
FREESTANDING SWING ARMS** -  
used between the couplers and the  
faucet body to create adjustable  
mounting widths.



Part: 300

**TUB WALL / BATHROOM WALL MOUNT SWING ARMS** -  
used between the faucet body and the tub or bathroom wall to create  
adjustable mounting widths.

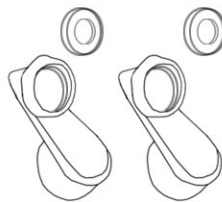

Part: 100

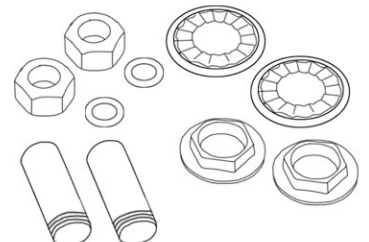

Deck Mount Hook Ups  
Part: T7550 included in box 100



# End Mount Shower Conversion Kit with Showerhead

by Randolph Morris

Item#: End Mount Shower Enclosure

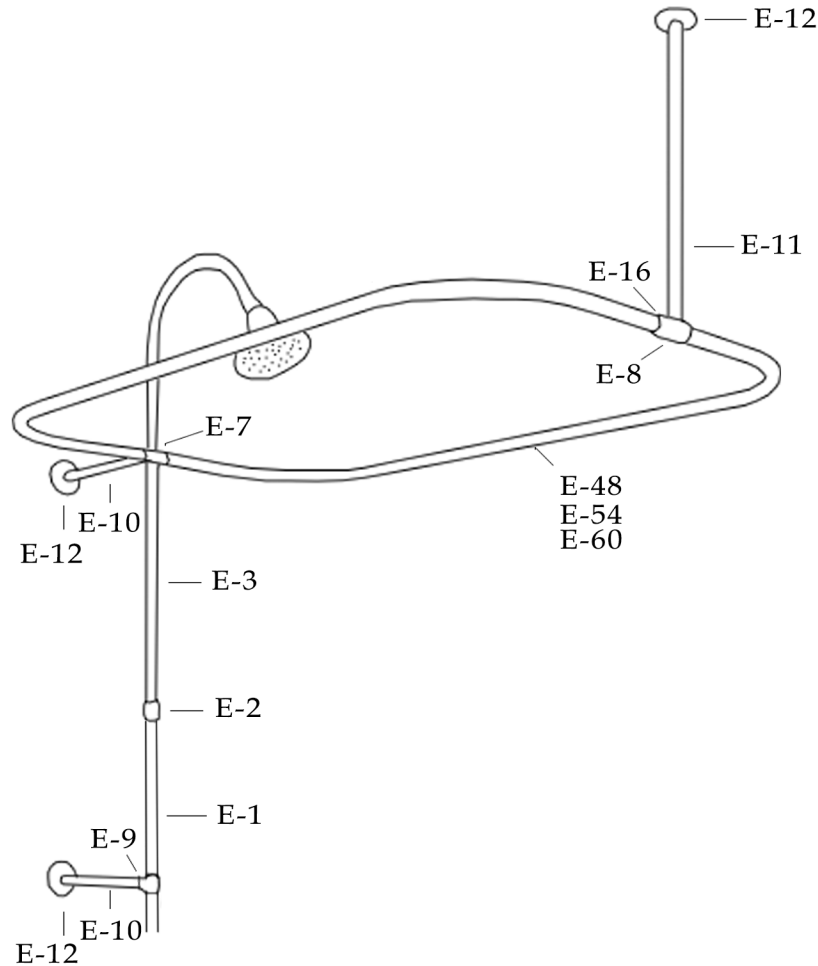

Unpack and check all the parts, and read the instructions.

PART NO.	DESCRIPTION	QTY	NOTES
E-1	48" Lower Riser Tube	1	
E-2	Riser Coupler	1	
E-3	28" Upper Riser Tube	1	
E-7	Riser Enclosure Connector	1	
E-8	Enclosure Connector	1	
E-9	5/8" Support Loop	1	Includes Set Screw
E-10	10" Wall Support Tube	2	
E-11	30" Ceiling Support Tube	1	
E-12	Wall/Ceiling Flange	3	Screws Not Included
E-16	Aluminium Compression Sleeve For 5/8" Tubing	1	
E-18	Entire Bag of Screws & Anchors	1	Not Shown
E-48	48" End Mount 'C' Tube	2	
E-54	54" End Mount 'C' Tube	2	
E-60	60" End Mount 'C' Tube	2	
E-DRYWALL SCREW	Drywall Screw (Finished)	6	Not Shown
E-SET SCREW	Set Screw	12	Not Shown
E-ALLEN SCREW	Allen Screw (No-Finish)	1	Not Shown
E-PLASTIC ANCHOR	Plastic Anchor	6	Not Shown
	Showerhead	1	Multiple Options

**Approximate Measurements.** All products and specifications are subject to change without notice. Randolph Morris is not responsible for typographical and/or dimensional errors. Typographical errors are subject to correction. *Note:* Rough-in dimensions may vary +/- 1/2" and are subject to change. No responsibility is assumed by Randolph Morris.