

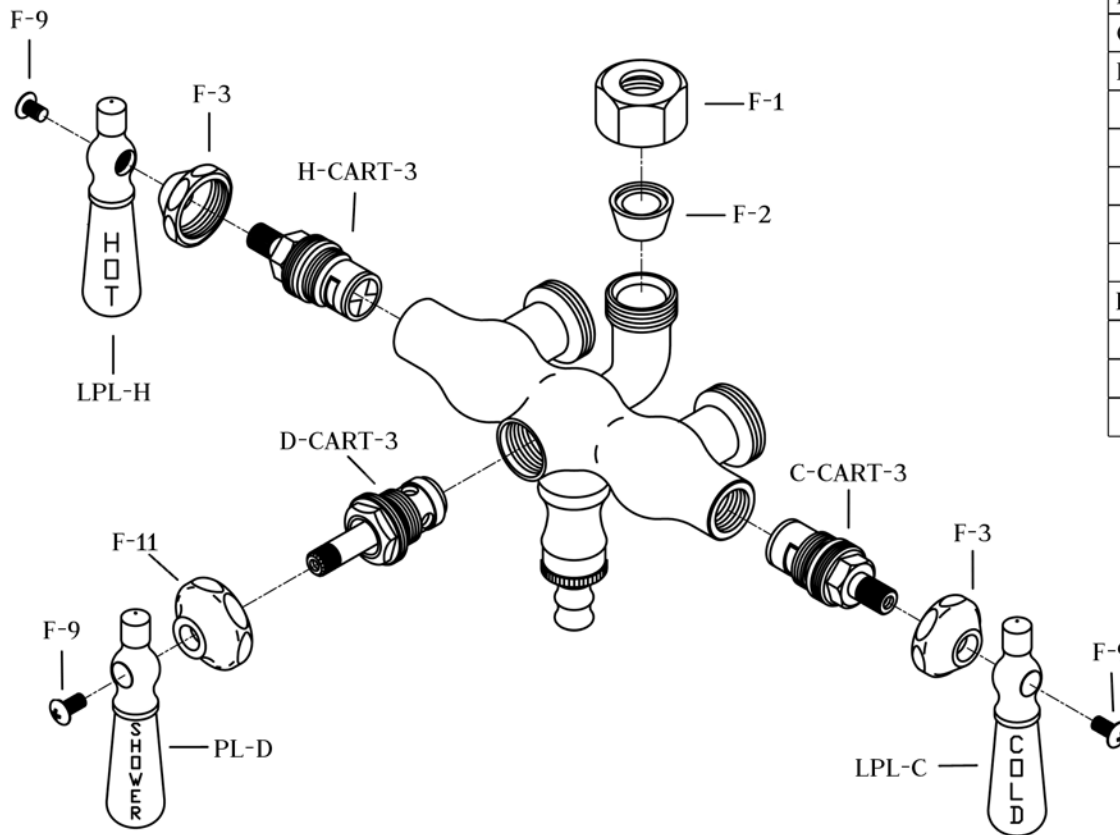

## Tub Downspout Faucet Body

by Randolph Morris

Item#: 006S



Unpack and check all the parts, and read the instructions.

PART NO.	DESCRIPTION	QTY
C-CART-3	COLD CARTRIDGE	1
D-CART-3	DIVERTER CARTRIDGE	1
F-1	RISER NUT	1
F-2	RISER CONE WASHER	1
F-3	BELL NUT	2
F-9	LEVER HANDLE SCREW	3
F-11	DIVERTER BELL FLANGE	1
H-CART-3	HOT CARTRIDGE	1
LPL-C	COLD LEVER HANDLE (LG)	1
LPL-H	HOT LEVER HANDLE (LG)	1
PL-D	DIVERTER LEVER HANDLE (LG)	1

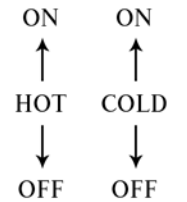

## COUPLER & SWING ARM PART SETS

**\*\*NOTE:** You may not receive all part sets listed below. Please refer to your order for your specific product.\*\*

**DECK MOUNT COUPLERS** - Either of these couplers can be used to attach a tub faucet to the rim of a tub.

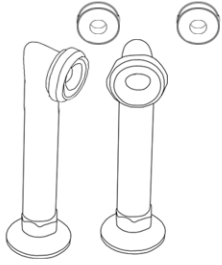

6" Deck Mount Couplers  
Part: 200

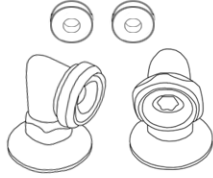

2" Deck Mount Couplers  
Part: 202

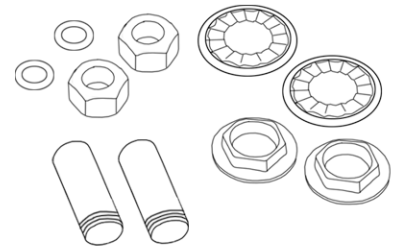

Deck Mount Hook Ups  
Part: T500 included in box 200 or 202

**BATHROOM WALL MOUNT COUPLERS** - Either of these couplers can be used to attach a tub faucet to the rim of a tub.

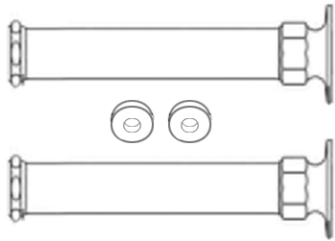

6" Bathroom Wall Mount Couplers  
Part: 170

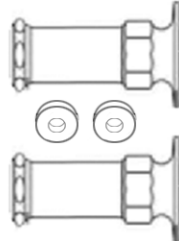

2" Bathroom Wall Mount Couplers  
Part: 160

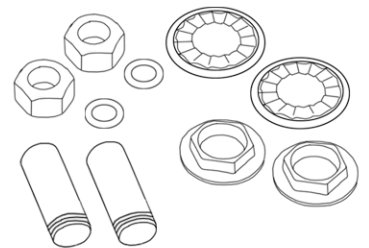

Tub & Bathroom Wall Mount Hook Ups  
Part: T7550 included in box 170 or 160

**TUB WALL MOUNT COUPLERS** - Either of these couplers can be used to attach a tub faucet to the inside wall of a tub.

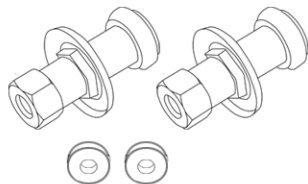

Straight Tub Wall Mount Couplers  
Part: 350

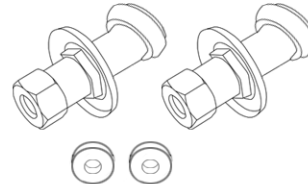

Adjustable Tub Wall Mount Couplers  
Part: A100

**DECK MOUNT /  
FREESTANDING SWING ARMS** -  
used between the couplers and the  
faucet body to create adjustable  
mounting widths.



Part: 300

**TUB WALL / BATHROOM WALL MOUNT SWING ARMS** -  
used between the faucet body and the tub or bathroom wall to create  
adjustable mounting widths.

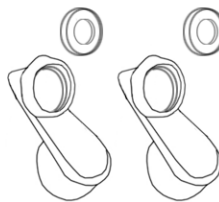

Part: 100

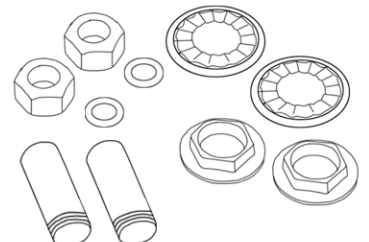

Deck Mount Hook Ups  
Part: T7550 included in box 100



# Parts List

## Side Mount Shower Conversion Kit with Showerhead by Randolph Morris

Item #: Side Mount Shower Enclosure

*Unpack and check all the parts, and read the instructions*

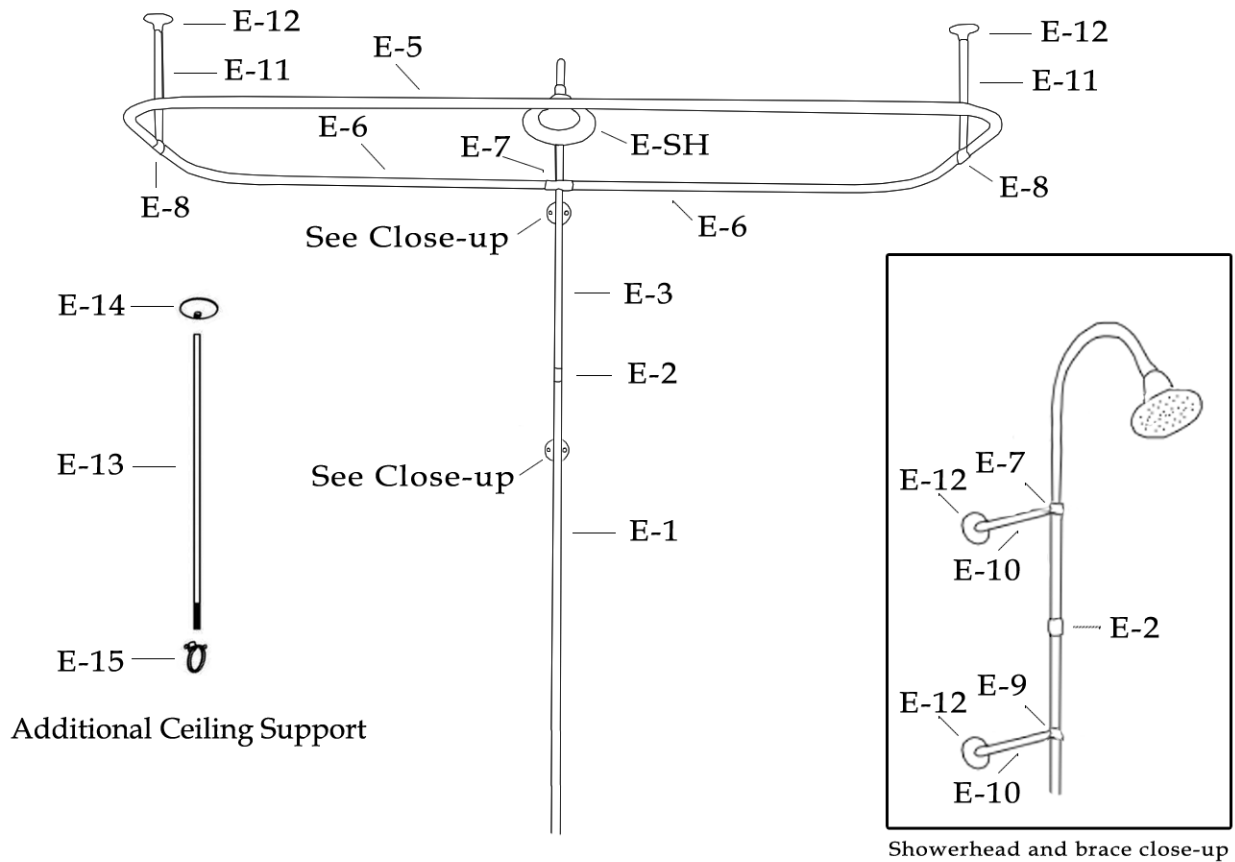

### PART LIST

- |                                     |   |
|-------------------------------------|---|
| E-1 - 48" Lower Riser Tube          | E-12 - Wall/Ceiling Flange                                |
| E-2 - Riser Coupler                 | E-13 - Additional Ceiling Support Tube 30" x 1/4"         |
| E-3 - 28" Upper Riser Tube          | E-14 - Additional Ceiling Support Flange 1/4" Opening     |
| E-5 - Side Mount Enclosure Tube "C" | E-15 - Additional Ceiling Support Loop 1/4" Connection    |
| E-6 - Side Mount Enclosure Tube "L" | E-SH - Shower Head – Multiple Options                     |
| E-7 - Riser Enclosure Connector     | E-Drywall Screw (Finished) - Included QTY 8 – Not Shown   |
| E-8 - Enclosure Connector           | E-Set Screw (Finished) - Included QTY 18 – Not Shown      |
| E-9 - 5/8" Support Loop             | E-Allen Screw (No-Finish) - Included QTY 1 – Not Shown    |
| E-10 - 10" Wall Support Tube        | E-Plastic Anchor (No-Finish) - Included QTY 8 – Not Shown |
| E-11 - 30" Ceiling Support Tube     |   |