

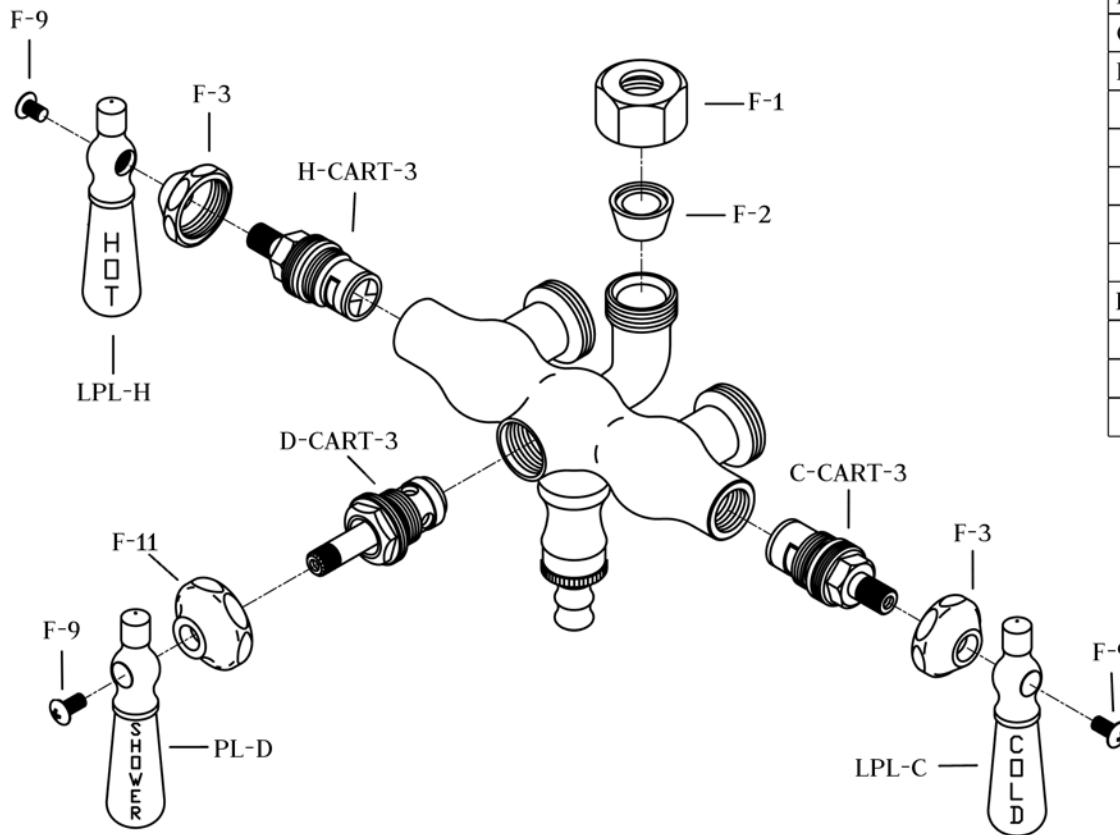

Tub Downspout Faucet Body

by Randolph Morris

Item#: 006S



Unpack and check all the parts, and read the instructions.

PART NO.	DESCRIPTION	QTY
C-CART-3	COLD CARTRIDGE	1
D-CART-3	DIVERTER CARTRIDGE	1
F-1	RISER NUT	1
F-2	RISER CONE WASHER	1
F-3	BELL NUT	2
F-9	LEVER HANDLE SCREW	3
F-11	DIVERTER BELL FLANGE	1
H-CART-3	HOT CARTRIDGE	1
LPL-C	COLD LEVER HANDLE (LG)	1
LPL-H	HOT LEVER HANDLE (LG)	1
PL-D	DIVERTER LEVER HANDLE (LG)	1

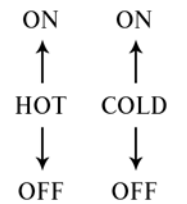

COUPLER & SWING ARM PART SETS

****NOTE:** You may not receive all part sets listed below. Please refer to your order for your specific product.**

DECK MOUNT COUPLERS - Either of these couplers can be used to attach a tub faucet to the rim of a tub.

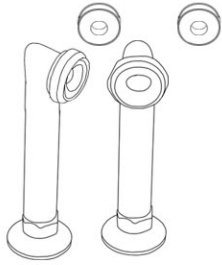

6" Deck Mount Couplers
Part: 200

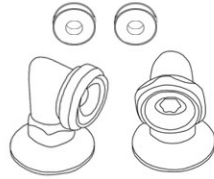

2" Deck Mount Couplers
Part: 202

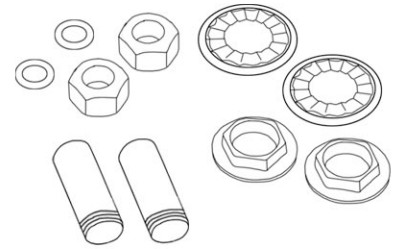

Deck Mount Hook Ups
Part: RMT500 included in box 200 or 202

BATHROOM WALL MOUNT COUPLERS - Either of these couplers can be used to attach a tub faucet to the rim of a tub.

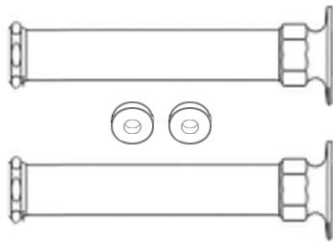

6" Bathroom Wall Mount Couplers
Part: 170

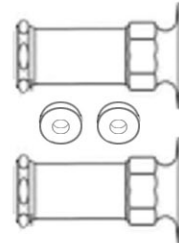

2" Bathroom Wall Mount Couplers
Part: 160

TUB WALL MOUNT COUPLERS - Either of these couplers can be used to attach a tub faucet to the inside wall of a tub.

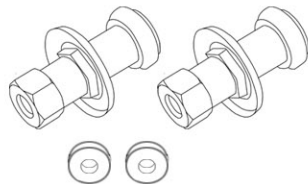

Straight Tub Wall Mount Couplers
Part: 350

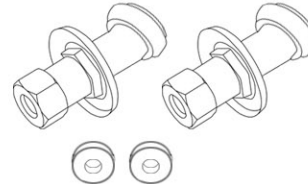

Adjustable Tub Wall Mount Couplers
Part: A100

**DECK MOUNT /
FREESTANDING SWING ARMS** -
used between the couplers and the
faucet body to create adjustable
mounting widths.



Part: 300

TUB WALL / BATHROOM WALL MOUNT SWING ARMS -
used between the faucet body and the tub or bathroom wall to create
adjustable mounting widths.

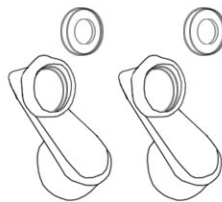

Part: 100

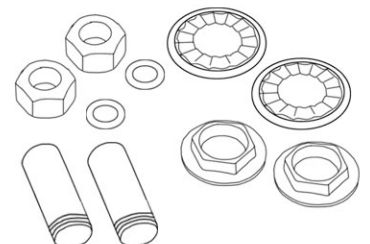

Deck Mount Hook Ups
Part: T7550 included in box 100

End Mount Shower Conversion Kit with Showerhead

by Randolph Morris

Item#: End Mount Shower Enclosure



Unpack and check all the parts, and read the instructions.

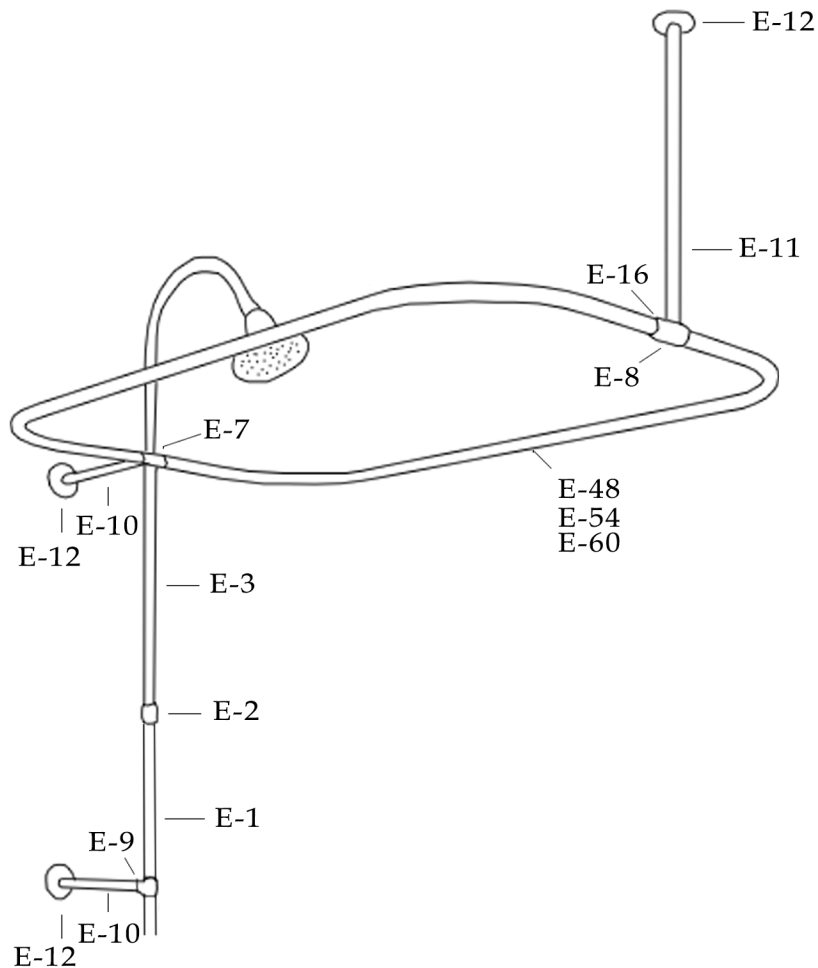

PART NO.	DESCRIPTION	QTY	NOTES
E-1	48" Lower Riser Tube	1	
E-2	Riser Coupler	1	
E-3	28" Upper Riser Tube	1	
E-7	Riser Enclosure Connector	1	
E-8	Enclosure Connector	1	
E-9	5/8" Support Loop	1	Includes Set Screw
E-10	10" Wall Support Tube	2	
E-11	30" Ceiling Support Tube	1	
E-12	Wall/Ceiling Flange	3	Screws Not Included
E-16	Aluminium Compression Sleeve For 5/8" Tubing	1	
E-18	Entire Bag of Screws & Anchors	1	Not Shown
E-48	48" End Mount 'C' Tube	2	
E-54	54" End Mount 'C' Tube	2	
E-60	60" End Mount 'C' Tube	2	
E-DRYWALL SCREW	Drywall Screw (Finished)	6	Not Shown
E-SET SCREW	Set Screw	12	Not Shown
E-ALLEN SCREW	Allen Screw (No-Finish)	1	Not Shown
E-PLASTIC ANCHOR	Plastic Anchor	6	Not Shown
	Showerhead	1	Multiple Options

Approximate Measurements. All products and specifications are subject to change without notice. Randolph Morris is not responsible for typographical and/or dimensional errors. Typographical errors are subject to correction. *Note:* Rough-in dimensions may vary +/- 1/2" and are subject to change. No responsibility is assumed by Randolph Morris.