

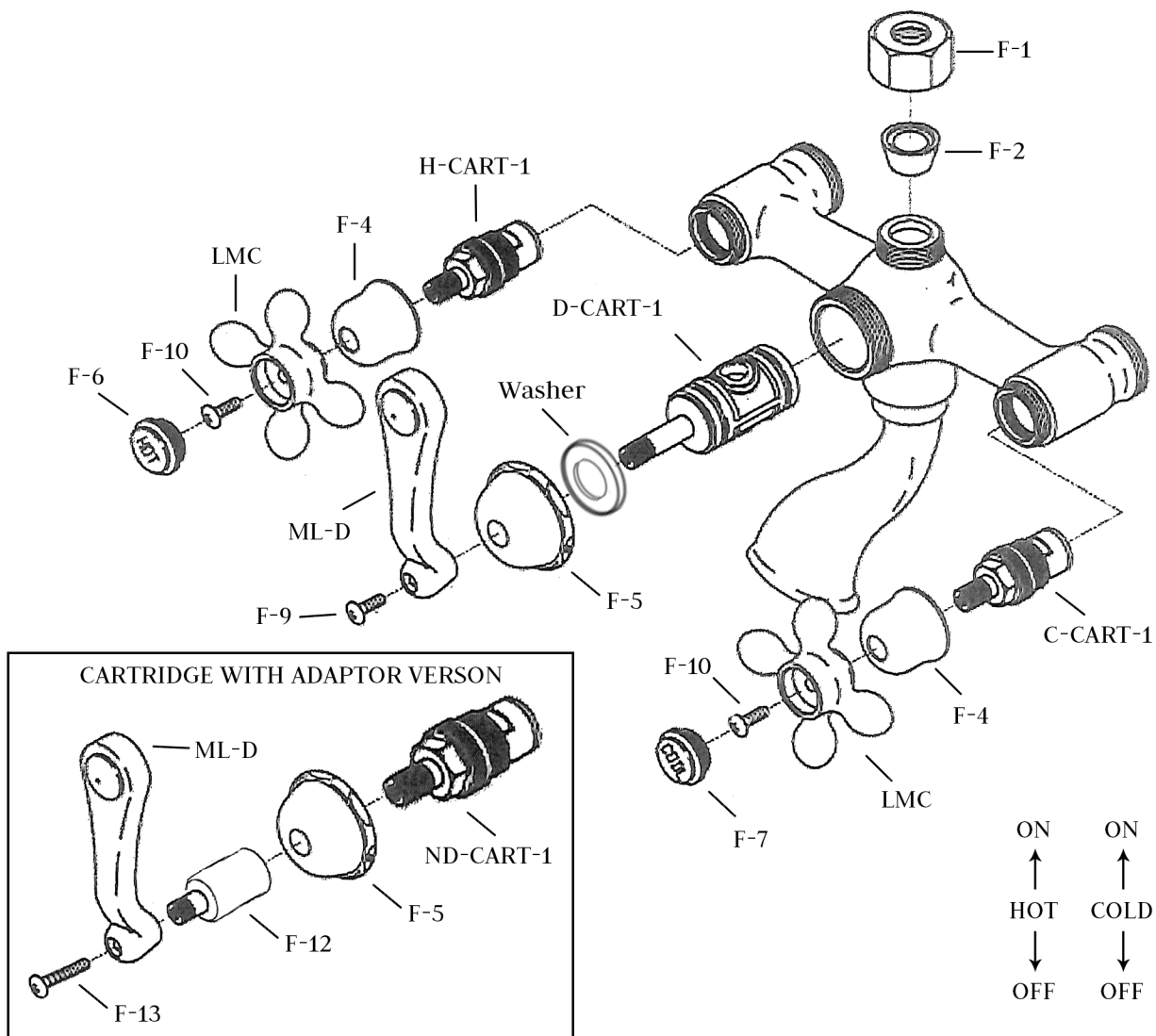

## English Telephone Faucet Body

by Randolph Morris

Item#: 146S



Unpack and check all the parts, and read the instructions.

| PART NO.  | DESCRIPTION                          | QTY |
|-----------|--------------------------------------|-----|
| C-CART-1  | COLD CARTRIDGE (BLUE)                | 1   |
| D-CART-1  | DIVERTER CARTRIDGE                   | 1   |
| F-1       | RISER NUT                            | 1   |
| F-2       | RISER CONE WASHER                    | 1   |
| F-4       | BELL NUT - HOT & COLD                | 2   |
| F-5       | DIVERTER BELL NUT                    | 1   |
| F-6       | HOT CERAMIC BUTTON                   | 1   |
| F-7       | COLD CERAMIC BUTTON                  | 1   |
| F-9       | FINISHED SCREW                       | 1   |
| F-10      | UNFINISHED SCREW                     | 2   |
| F-12      | ADAPTOR                              | 1   |
| F-13      | LONG FINISHED SCREW                  | 1   |
| H-CART-1  | HOT CARTRIDGE (RED)                  | 1   |
| LMC       | CROSS HANDLE                         | 2   |
| ML-D      | DIVERTER HANDLE                      | 1   |
| ND-CART-1 | DIVERTER CARTRIDGE (ADAPTOR VERSION) | 1   |

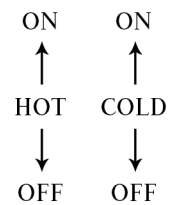

**Approximate Measurements.** All products and specifications are subject to change without notice. Randolph Morris is not responsible for typographical and/or dimensional errors. Typographical errors are subject to correction.

## COUPLER & SWING ARM PART SETS

**\*\*NOTE:** You may not receive all part sets listed below. Please refer to your order for your specific product.\*\*

**DECK MOUNT COUPLERS** - Either of these couplers can be used to attach a tub faucet to the rim of a tub.

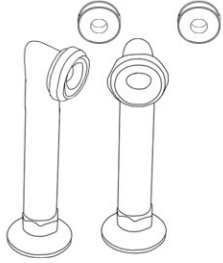

6" Deck Mount Couplers  
Part: 200

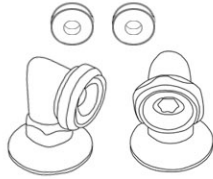

2" Deck Mount Couplers  
Part: 202

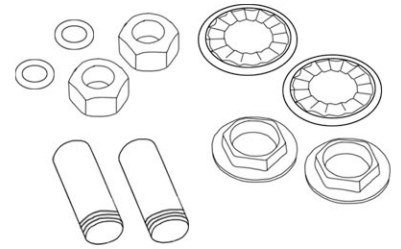

Deck Mount Hook Ups  
Part: RMT500 included in box 200 or 202

**BATHROOM WALL MOUNT COUPLERS** - Either of these couplers can be used to attach a tub faucet to the rim of a tub.

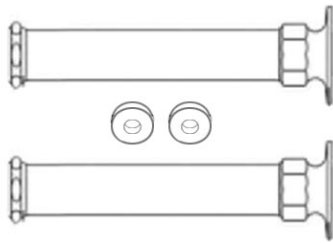

6" Bathroom Wall Mount Couplers  
Part: 170

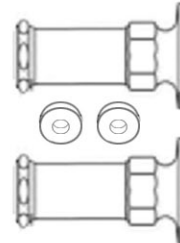

2" Bathroom Wall Mount Couplers  
Part: 160

**TUB WALL MOUNT COUPLERS** - Either of these couplers can be used to attach a tub faucet to the inside wall of a tub.

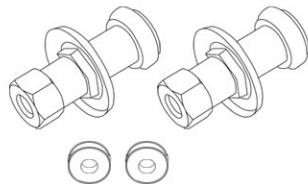

Straight Tub Wall Mount Couplers  
Part: 350

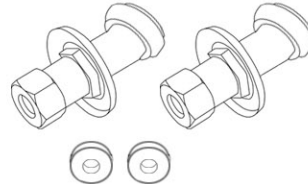

Adjustable Tub Wall Mount Couplers  
Part: A100

**DECK MOUNT /  
FREESTANDING SWING ARMS** -  
used between the couplers and the  
faucet body to create adjustable  
mounting widths.

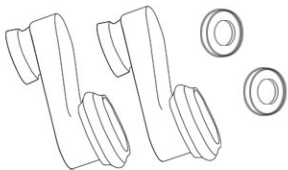

Part: 300

**TUB WALL / BATHROOM WALL MOUNT SWING ARMS** -  
used between the faucet body and the tub or bathroom wall to create  
adjustable mounting widths.

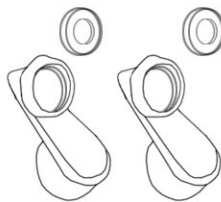

Part: 100

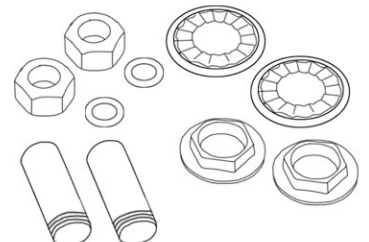

Deck Mount Hook Ups  
Part: T7550 included in box 100