

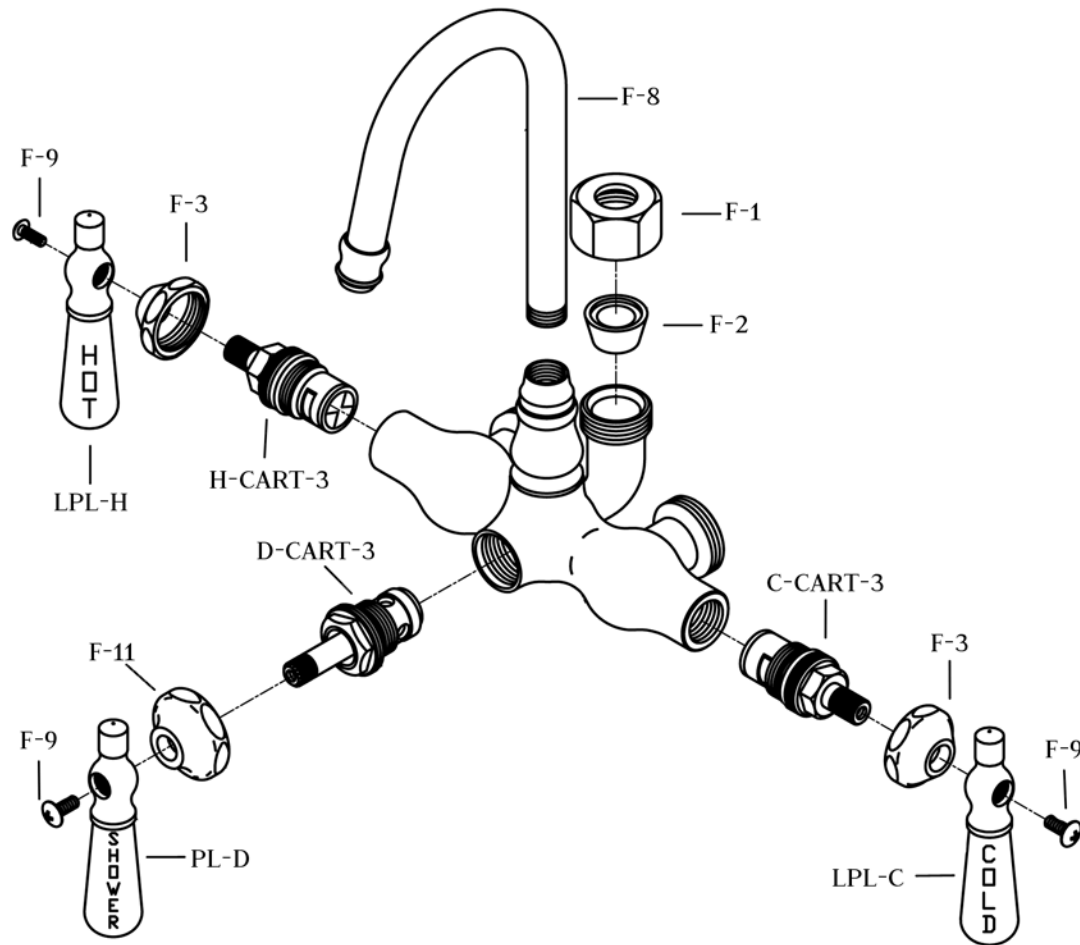

## Tub Gooseneck Faucet Body

by Randolph Morris

Item#: 400S



Unpack and check all the parts, and read the instructions.

PART NO.	DESCRIPTION	QTY
C-CART-3	COLD CARTRIDGE (BLUE)	1
D-CART-3	DIVERTER CARTRIDGE	1
F-1	FAUCET RISER NUT	1
F-2	FAUCET RISER CONE WASHER	1
F-3	CARTRIDGE BELL COVERS	2
F-8	GOOSENECK SPOUT*	1
F-9	LEVER HANDLE SCREW	3
F-11	DIVERTER BELL FLANGE	1
H-CART-3	HOT CARTRIDGE (RED)	1
LPL-C	COLD LEVER HANDLE (LG)	1
LPL-H	HOT LEVER HANDLE (LG)	1
PL-D	SHOWER LEVER HANDLE (LG)	1

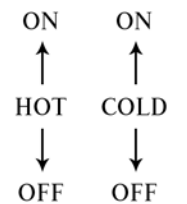

\*Spout is packed in the bottom of the styrofoam insert in box.



# Handshower & Cradle

by Randolph Morris

Item#: 144B

Unpack and check all the parts, and read the instructions.

PART NO.	DESCRIPTION	QTY
CK-1	HANDSHOWER HEAD	1
CK-2	HANDSHOWER HANDLE	1
CK-3	HANDSHOWER HOSE	1
CK-4	HANDSHOWER HOSE WASHERS	2
CK-10	HANDSHOWER FAUCET CRADLE	1
CK-11	HANDSHOWER CRADLE WASHER	1

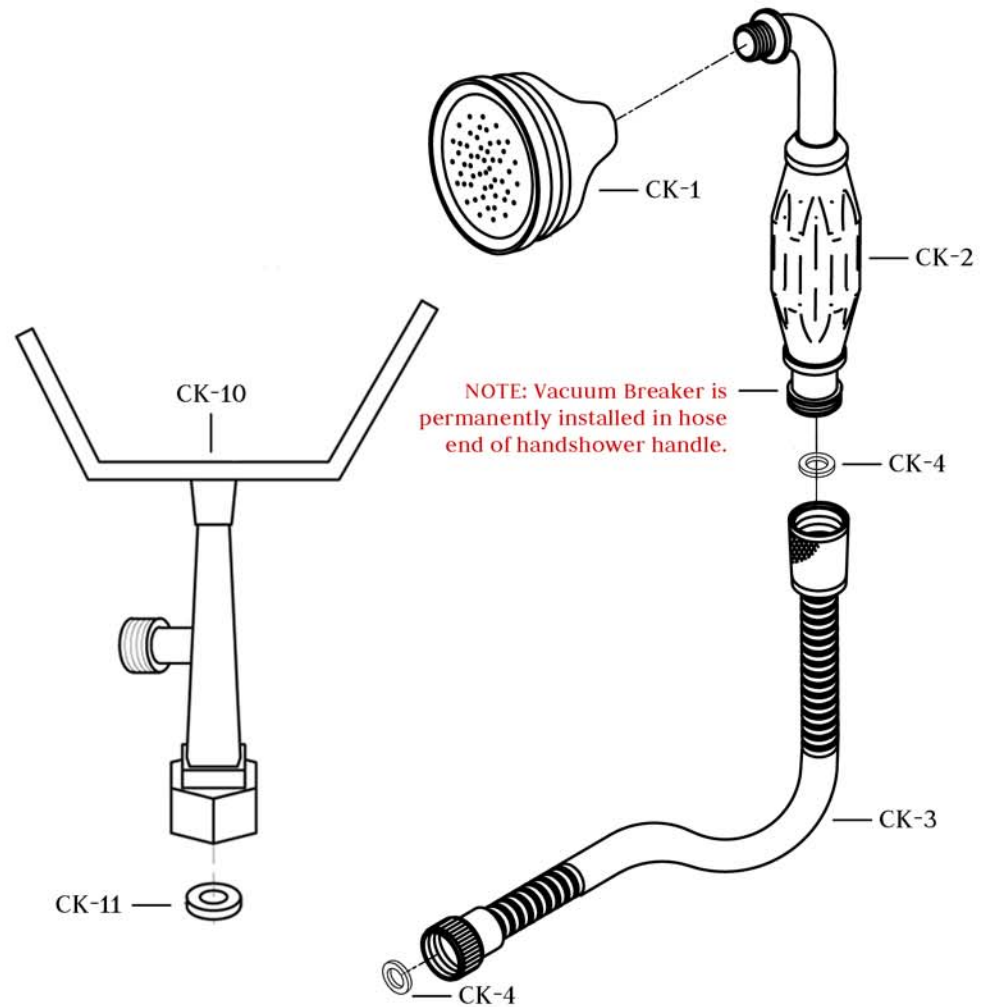

## COUPLER & SWING ARM PART SETS

**\*\*NOTE:** You may not receive all part sets listed below. Please refer to your order for your specific product.\*\*

---

**DECK MOUNT COUPLERS** - Either of these couplers can be used to attach a tub faucet to the rim of a tub.

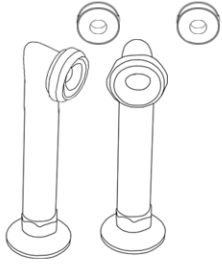

6" Deck Mount Couplers  
Part: 200

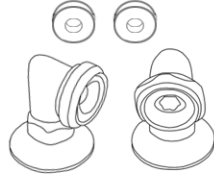

2" Deck Mount Couplers  
Part: 202

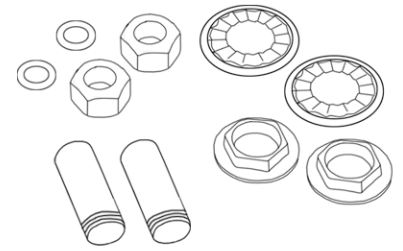

Deck Mount Hook Ups  
Part: T500 included in box 200 or 202

---

**BATHROOM WALL MOUNT COUPLERS** - Either of these couplers can be used to attach a tub faucet to the rim of a tub.

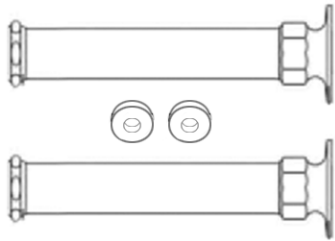

6" Bathroom Wall Mount Couplers  
Part: 170

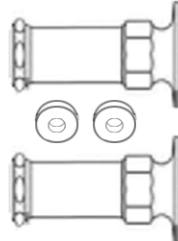

2" Bathroom Wall Mount Couplers  
Part: 160

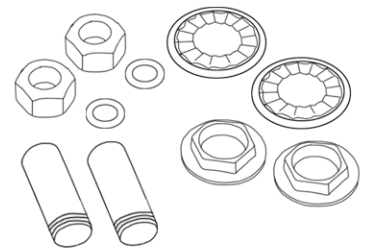

Tub & Bathroom Wall Mount Hook Ups  
Part: T7550 included in box 170 or 160

---

**TUB WALL MOUNT COUPLERS** - Either of these couplers can be used to attach a tub faucet to the inside wall of a tub.

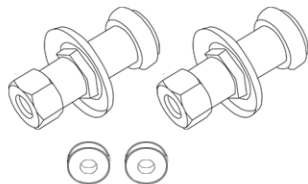

Straight Tub Wall Mount Couplers  
Part: 350

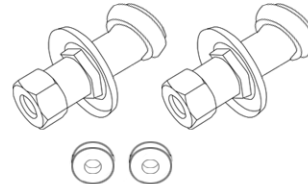

Adjustable Tub Wall Mount Couplers  
Part: A100

---

**DECK MOUNT /  
FREESTANDING SWING ARMS** -  
used between the couplers and the  
faucet body to create adjustable  
mounting widths.



Part: 300

**TUB WALL / BATHROOM WALL MOUNT SWING ARMS** -  
used between the faucet body and the tub or bathroom wall to create  
adjustable mounting widths.

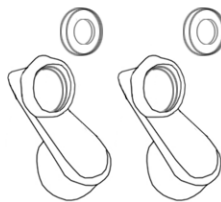

Part: 100

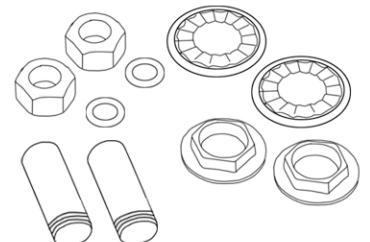

Deck Mount Hook Ups  
Part: T7500 included in box 100