

Bathtub Widespread Faucet Installation Guide

Technical Parameters:

- Recommended Water Pressure: 30-70 PSI
- Recommended Hot Water Temperature: 100 °F - 120°F
- Highest Hot Water Temperature: 170°F
- Handle Maximum Hole Diameter: 1-3/8" (35 mm)
- Spout Handle Maximum Hole Diameter: 1½" Ø hole (38 mm)
- Maximum Thickness: 1-3/16" (30 mm)

Required Tools:



Adjustable wrench

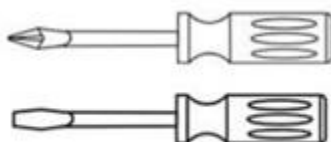

screwdriver

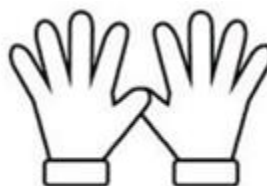

gloves

Note: The factory installed cartridge in the main valve bodies have been tested and adjusted. Do not remove.



Do not take the faucet apart

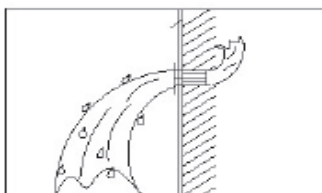

Keep the supply pipes unblocked

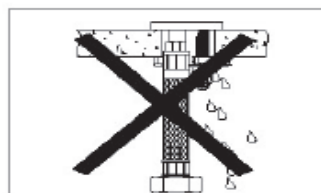

No leakage in the connection

Parts List:

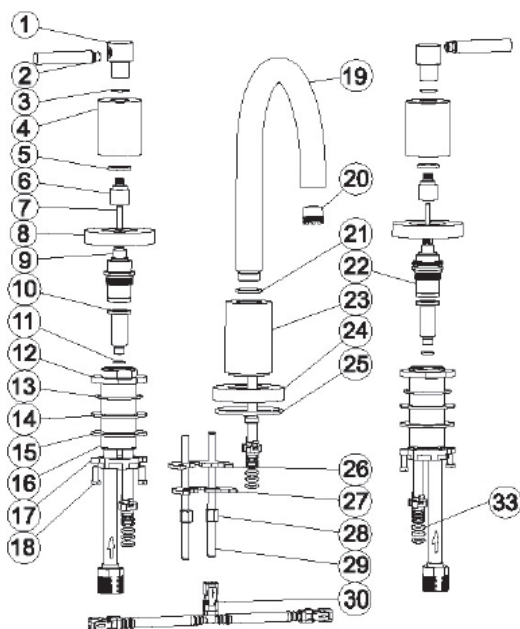

ITEM	DESCRIPTION
35	American pop-up
34	Plastic spanner
33	O-ring
32	Lift rod
31	Cap
30	Hose
29	Thread rod
28	Tightening Nut
27	C metal gasket
26	C rubber gasket
25	O-ring
24	Base
23	Body
22	½ Cartridge(Cold)
21	O-ring
20	Aerator gule
19	Spout
18	M4 Screw
17	Tightening Nut
16	Valve body
15	Rubber gasket
14	Gasket
13	O-ring
12	Nut
11	O-ring
10	Tube
9	½ Cartridge(Hot)
8	Base
7	M4 Screw
6	Cartridge sleeve
5	Gasket
4	Handle base
3	Gasket
2	Handle rod
1	Handle body

Installation Steps

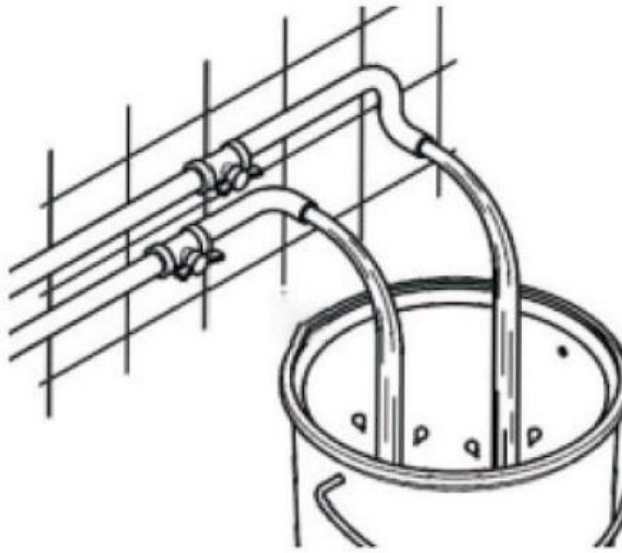

1. Please flush the water pipe for at least 2 mins before installation to ensure that there are no impurities. Hot and Cold Water Suppliers should come from an angle outward

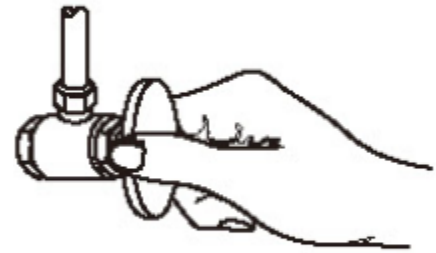

2. Turn off the water supply lines. Clean all dirt and particles. If you are replacing an existing faucet, remove the faucet from the sink and clean the sink surface thoroughly.

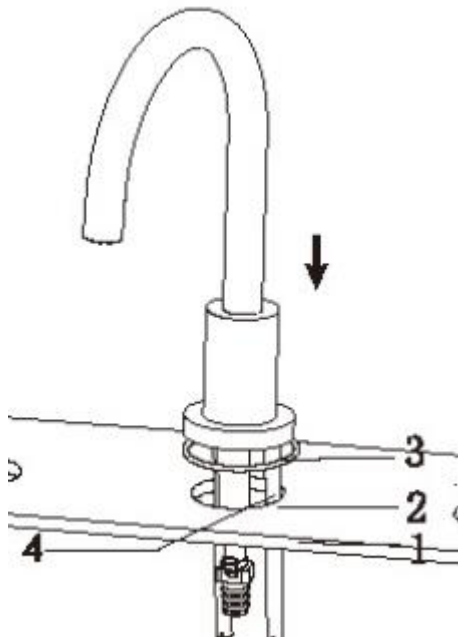

3. Drill a 1-1/2" hole (2) in sink top (1). Install the fastening bolts (4) and tighten. Install O-Ring (3) into groove on base plate and insert faucet through the hole (2).

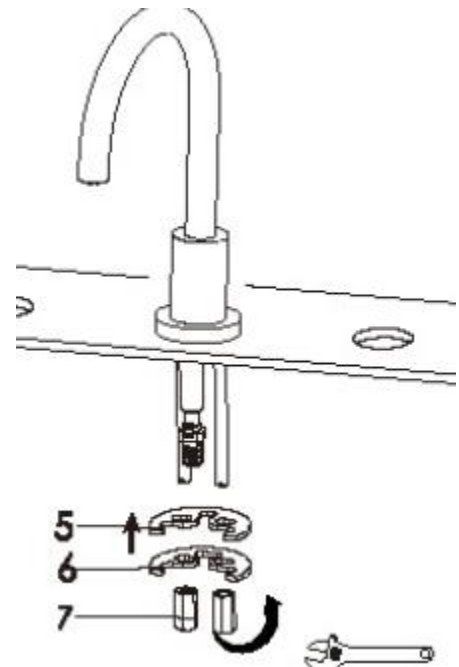

4. Align the faucet to the right position, install the rubber washer (5) and metal washer (6) onto fastening bolts and tighten with nuts (7)

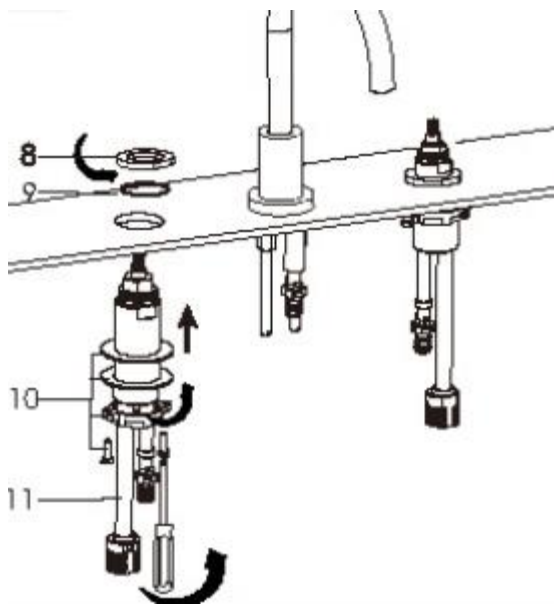

5. Insert the valve bodies (11) through the 1-1/8 hole from underneath, then install the O-ring (9) and the locknut (8) from above and tighten.
(Typical for 2)

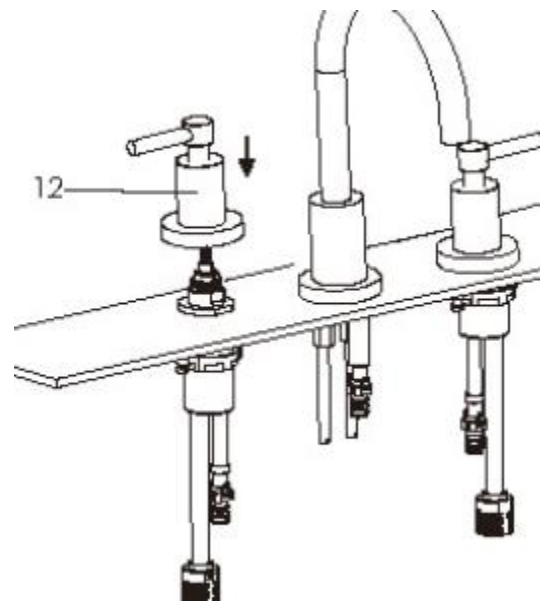

6. Lock the handle (12) on the valve bodies firmly.
(Typical for 2)

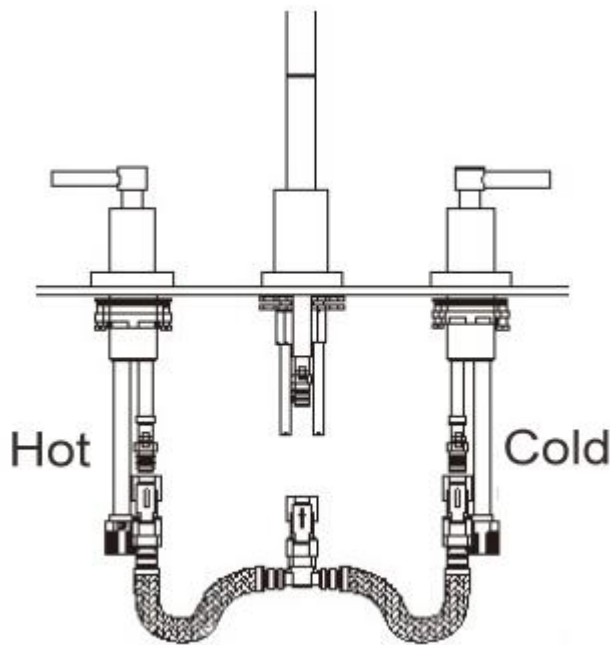

7. Connect the flexible hoses to the valve bodies. Left hose is for hot water and right is for cold.

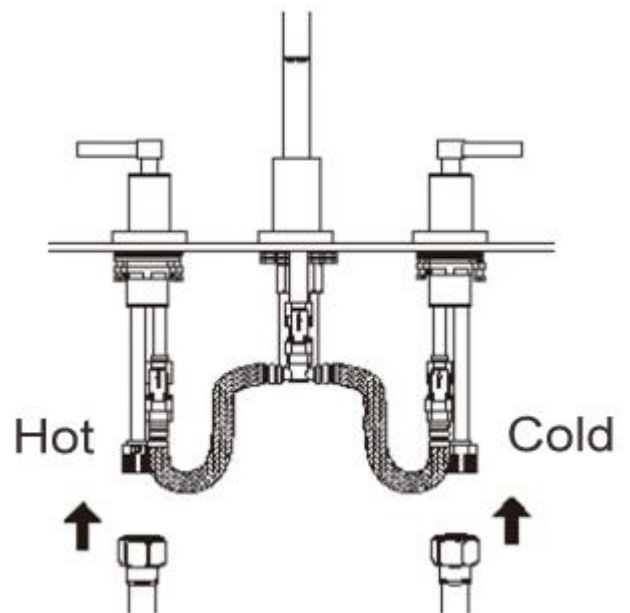

8. Connect the valve bodies with the valve outlet with flexible hoses.

Operation and Maintenance

Modern bathroom faucets, kitchen faucet, and shower products are made of different materials to meet the design and functionality of the market

- Clean with a soft cloth or a sponge and soapy water.
- Rinse thoroughly and wipe dry; drying the fixture immediately after use helps prevent lime deposits from forming.
- To protect the finish, do not use abrasive agents, polish abrasives or acid-containing harsh cleaners.