



# One Piece Toilet Installation Guide

## Before You Start

We recommend using a professional plumbing installer if you are unfamiliar with vintage style bathroom fixtures and plumbing. Vintage Tub & Bath will not be responsible for any damage to the floor, walls, plumbing, or personal injury during installation. Please review all local plumbing and building codes to be sure your purchase is code compliant for your area.

**Tools Needed:** Pencil, Hacksaw, Level, Drill, Adjustable Wrench, PVC Glue

**Materials Included:** NA

\*\*\* For the following installation instructions for your new toilet it is assumed that any old fixtures have been removed and that the toilet flange is in the proper location for installation (refer to specification sheet). Unpack and inspect the product for any shipping damages. If you find any damages, do not install. Shut off the water supply lines where the toilet is being installed.

### 1. Remove Old Toilet

Close Toilet supply valve and flush tank completely, use a towel or sponge to remove excess water. Disconnect and remove supply line. Remove old mounting hardware, remove toilet and plug floor waste opening to prevent escaping gas.

### 2. Measure the Rough-in

Measure the wall from behind the toilet to the middle of the closet bolt

**\*\*\*NOTE: Your rough-in measurement should be about 12 inches.\*\*\***

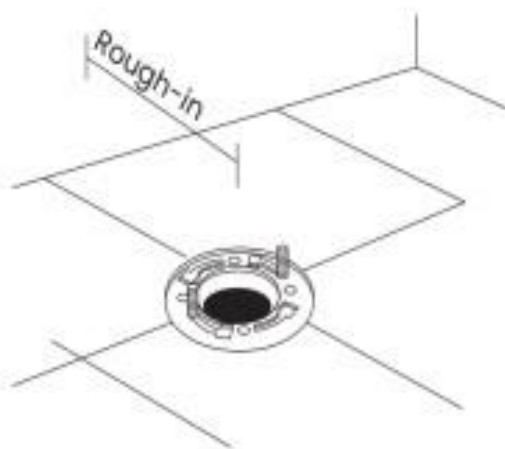

# One Piece Toilet Installation Guide

3. Install Closet Bolts  
Install closet bolts to flange, turn 90 degrees.

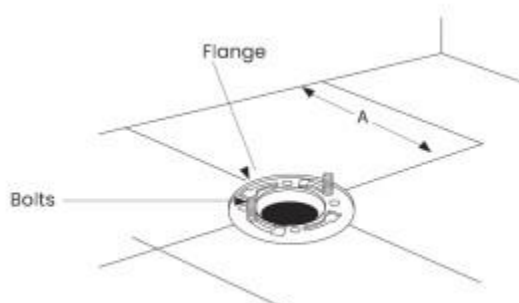

4. Install Wax Seal  
Invert toilet on floor (use cushion to prevent damage) and install the wax ring evenly around the waste flange with tapered end of ring facing toilet. Apply a thin bed of sealant around toilet base.

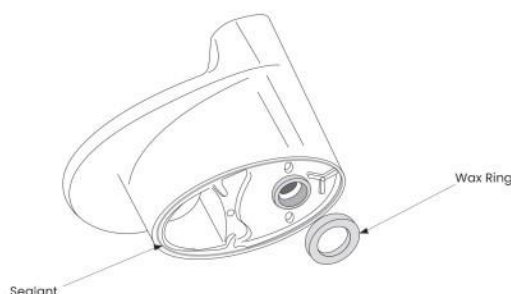

5. Position Toilet on Flange  
Unplug floor waste opening and install toilet on the closet flange so bolts project through mounting holes. Loosely install washers and nuts.

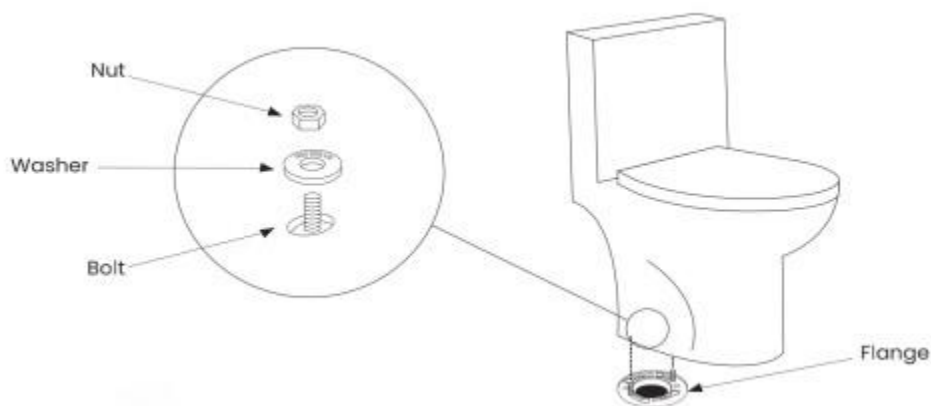

# One Piece Toilet Installation Guide

6. Install the toilet

Position toilet square to wall and, with a rocking motion, press bowl down fully on wax ring and flange. Alternately tighten nuts from the back of the toilet.

**\*\*\*NOTE: Do not overtighten nuts as it might crack the ceramic.\*\*\***

Smooth off the beat of sealant around the base. Remove excess sealant.

