



LIGHTED MIRROR INSTALLATION

DANGER – To reduce the risk of electric shock:

- Always unplug the power cord before cleaning around the electrical components.

WARNING – To reduce the risk of burns, fire, electric shock, or injury:

- Unplug from outlet before putting on or taking off parts.
- Children should be supervised to ensure that they do not play with the appliance.
- Use this only for its intended use as described in these instructions.
- Never operate this furnishing if it has a damaged cord or plug. If it is not working properly or dropped; Return this product to a service center for examination and repair.
- Never drop or insert any object into any opening.
- For household and dry locations use only.
- Never operate the product with air openings blocked. Keep air openings free of lint, hair, and the like.
- Do not operate where aerosol (spray) products are being used or where oxygen is being administered.

Before Installation

- Vintage Tub & Bath is not responsible for any damage to the unit or personal property caused by improper installation. If you disregard instructional warnings, you will void your warranty
- Unpack and inspect the mirror for any damage. If any damage is found, please contact our Customer Relations team at 877.868.1369

Mounting Options

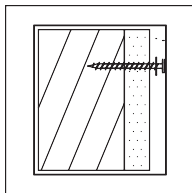

Stud Wall: Secure mirror to wall using screw at marked stud locations

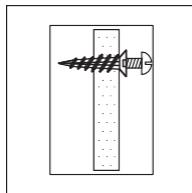

Drywall: Screw wall anchor flushed into wall location. Secure mirror onto wall using provided screws into wall anchor

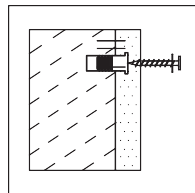

Concrete Wall: Drill hole at marked locations, then insert wall anchors into holes. Secure mirror to wall using fasteners (Not included)

Tools and Materials

- Phillips screwdriver, tape measure, leveler



LIGHTED MIRROR INSTALLATION

Prep

- Check that you have all required materials before installation; if any part is missing or damage, do not attempt to assemble the product

Installation

1. Determine desired location for the mirror. Consider that you should have a 3" minimum clearance between the bottom of the mirror and top of the faucet/vanity.
 - **NOTE:**
 - i. Make sure it is level
 - ii. Installation location must have a power outlet to use product to it's fullest potential
2. Install screw using the hardware best suited for your wall type. Refer to **Mounting Options** above. Be careful to not drill into hidden electrical or plumbing lines inside the wall when mounting.
3. Align screw with the bracket that is behind the mirror. Carefully lower the mirror on to the screw. Make sure mirror is fully seated and secure before releasing the mirror.

Operating Instructions

- The touch switch on the front of the mirror is to turn the back light ON/OFF. When the back light is on the button color will glow blue; when it is off it will glow white.
 - **Motion Sensor:**
 - If mirror has motion sensor; the sensor will turn on when you are near it. The range is between 24" to 40". The mirror will turn off 20 seconds after leaving the sensors range.
 - **Dimmable Light:**
 - When the light is powered on, press, and hold the power button for about 3 seconds. The brightness will scroll up then back down. Take your finger off the touch button to leave the brightness at the setting you choose. This same brightness will be kept when the light is turned off. To adjust brightness, repeat the steps.
 - **Defrost:**
 - The defrost setting automatically turns on when the light is on.

Care and Maintenance

- The glass can be cleaned using standard household glass cleaning products
- Any other services should be performed by a professional