



## INSTALLATION INSTRUCTIONS MAJESTIC FREESTANDING 2051.

The Freestanding Majestic Dispenser can be used to provide soap, lotion, shampoo etc. at or adjacent to your washing facility. The heavy brass base can be permanently fixed to a surface where it will most often be used. The Bottle can be removed from the Base for cleaning. Both the Brass Base and the Bottle have a rubber gasket to minimise slipping.

### OPERATION

The Dispenser is assembled ready for use, all you have to do is fill the Bottle with your choice of liquid. The most convenient way to do this is simply to pull the Head, Pump and Tube Assembly out of the Flange and fill the Bottle through the hole in the Flange as illustrated below\*. Leave a small space in the top of the Bottle as the Head, Pump and Tube Assembly will displace some liquid when it is replaced. After filling the Bottle wipe the inside of the Flange with a cloth to remove any excess liquid and replace the Head, Pump and Tube Assembly. You will then need to prime the Pump by pressing on the top of the Head several times.

A sharp, positive action on the top of the Head will dispense 1ml (1/30th Fl.oz) of liquid at 45° to the work surface from the end of the spout. **NOTE** If problems are encountered in priming the pump with soap or lotion, we suggest that water should be used initially. Once water has been pumped successfully, simply transfer the unit back to the soap or lotion and keep pumping until all the water is discharged, and your chosen liquid emerges.

### MAINTENANCE

If the Dispenser is not used for several weeks, the liquid in the Pump may become congealed, especially in cold conditions. The Head, Pump and Tube Assembly should be removed and warm water allowed to run down through the Tube while the Pump is operated. The unit will function normally when replaced. Occasionally colour changes will occur in the liquid ejected. This is harmless, but another liquid should be used as a replacement.

In order to clean the Bottle, remove the Head, Pump and Tube Assembly then unscrew and remove the Flange from the Bottle Cap taking care not to misplace the small 'O' Ring. Then clean the Bottle in warm water. **Do Not use a dishwasher or any abrasive cleaning materials.**

Replace the Bottle Cap and screw on the Flange with the 'O' Ring trapped between it and the Bottle Cap and replace the Head Assembly. Do Not overtighten the Flange as this will make it difficult to remove it in the future.

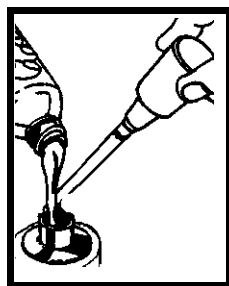

Filling.

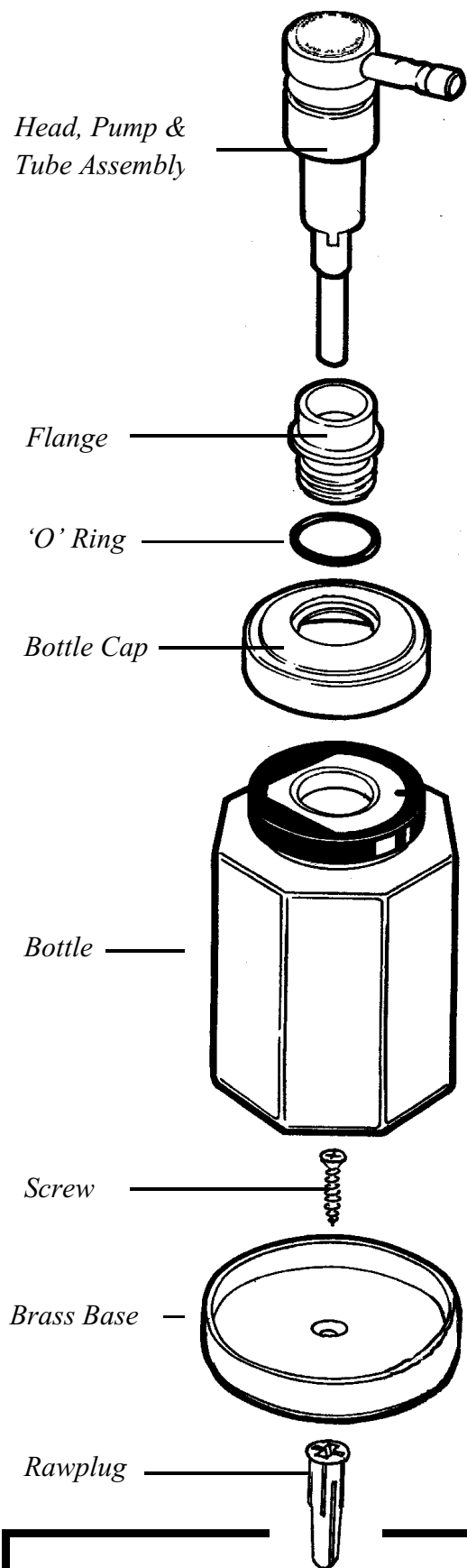

### \*WARNING\*

#### THE BOTTLE IS MADE OF GLASS.

Ensure that you hold the bottle firmly on the surface while you are operating or filling the dispenser to avoid it slipping away.

When carrying the dispenser use two hands and ensure it and your hands are not slippery.

Remember that the Head, Pump & Tube Assembly and the Brass Base are not securely fixed to the rest of the Dispenser.

This product is **not** recommend for the shower. There are other products in the Hollys Dispenser range that are more suitable.